



Mercedes Sprinter 2007 Model LWB & XLWB Custom Moulded Tanks

Atlas Tanks now offers a set of moulded tanks specifically for the 2007 model Mercedes Benz Sprinter - high roofed, long wheel base and extra long wheel base vehicles.

How they come

There are 2 tanks for each vehicle. These tanks can be used for either freshwater or greywater depending on your plumbing arrangements.

Can they be changed

The tank shape and sizes are fixed but the plumbing fitting location and sizes will be customised to suit your particular installation.

Will they be visible

When installed correctly the tanks will all fit up above the vehicle sill and will not be seen.

Tank Construction

These tanks are moulded from food grade polyethylene. Polyethylene is very strong, highly impact resistant and will not rust or corrode.

What about Installation

Each tank has been designed to fit in one location only. The tanks would best be installed by using a metal strap from the body under the tank and fixing back onto the body or chassis.

Warranty

As with all Atlas Tanks they are covered by a 5 Year Guarantee against workmanship and defect.

**Mercedes Sprinter/
Volkswagen LT
Tank locations**

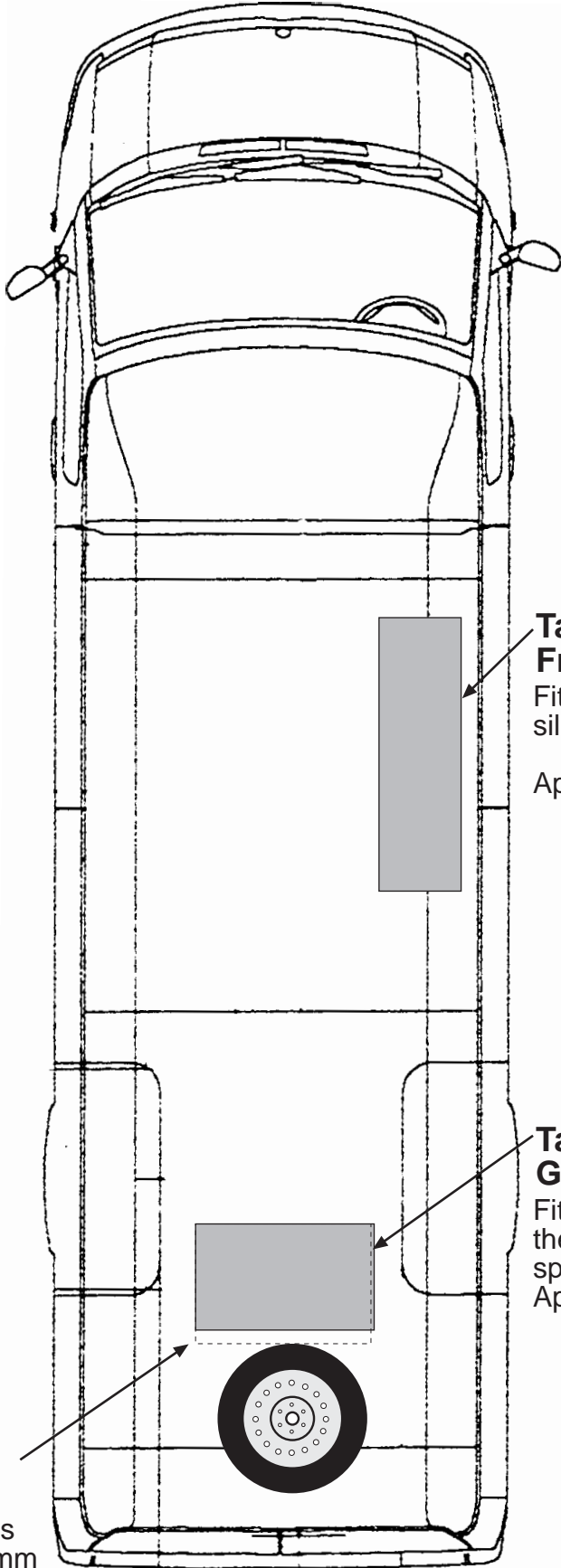

**Tank 2 Greywater or
Freshwater**

Fits between chassis rail and sill.

Approximate capacity 110 litres.

**Tank 1 Freshwater or
Greywater**

Fits behind diff and finishes below the cross-member in front of the spare wheel.

Approximate capacity 86 litres.

**Tank 1a Freshwater or
Greywater**

Suitable for the Extra Long Wheel Base vehicle only. This tank measures an extra 250mm in length.

Approximate capacity 120 litres.



Fittings

Freshwater Tanks

Inlets, outlets, breathers and connectors will be fitted to the tanks as BSPT female threaded ports. The location of these ports will be customised to suit your installation. Mark on the drawings and return back to Atlas Tanks with the How To Order form.

We recommend the following size fittings:

Filler:	1" or 1 1/2 " depending on filler point type*
Outlet to pump	1/2"
Breather	1/2" or 3/8" depending on filler point type*

*Filler point type

Each of the filler types has different filler and breather pipe diameters. Please check the type you intend using to ensure you have the right fitting sizes.

Greywater Tank

Fittings in the greywater tank will need to suit appliances.

We recommend the following sizes:

Inlets:	1 1/2"
Outlet:	1 1/2"
Breather:	3/4" at least 50% of outlet size

Tank Installation

Installation

The tanks have been designed to be installed and held in position by metal straps. Ideally the straps should be about 50 mm wide. We do not supply the straps.

- 2 Straps on each of the freshwater tanks
- 3 Straps on the greywater tank



How to Order

Tanks Required (please tick)

Tank 1 - 86 litre - \$289 + gst

Tank 1a - XLWB - \$369 + gst

Tank 2 - 110 litre - \$345 + gst

Fitting Location and Sizes

Using the drawings provided please clearly indicate where you require your inlets, outlets, breathers and connectors.

Special Instructions

Order Information

Name of company: _____

Contact person: _____

Delivery Address: _____

Postal Address : _____

Phone Number: _____

Fax Number: _____

Tanks Required by: _____

Atlas Tanks, 18 Allen Street, Moffat Beach, QLD 4551
Phone: (07) 5438 2310 Fax: (07) 5438 2318

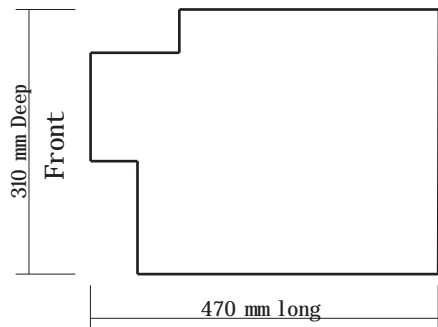

Passengers Side

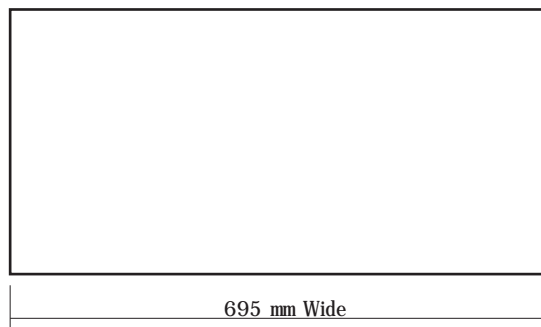

Rear View

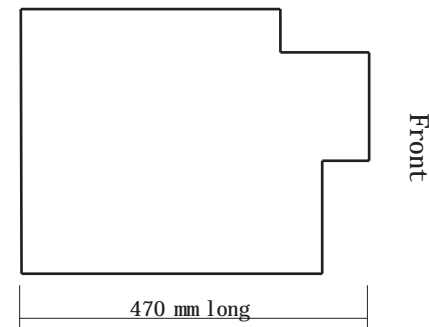

Drivers Side

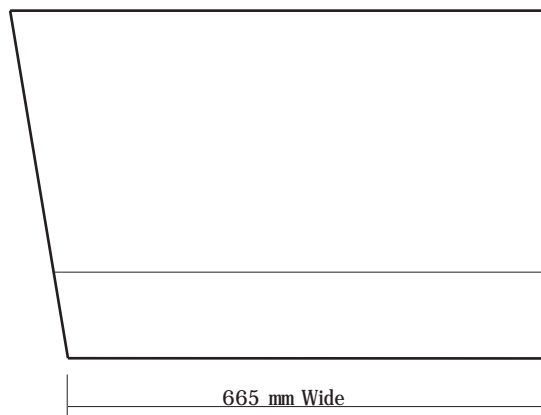
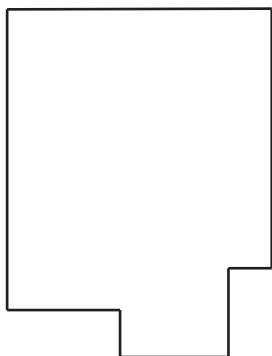

Plan View

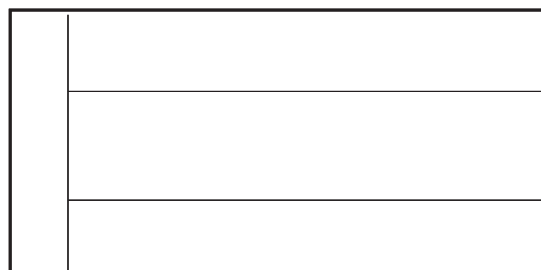
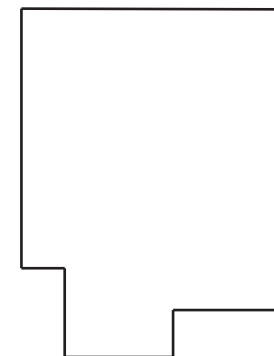

Front View

Please clearly mark where you require fitting locations and sizes.

Mercedes Sprinter 2007 Model

Tank: Tank One 86 litres

Atlas Tanks | January 2007

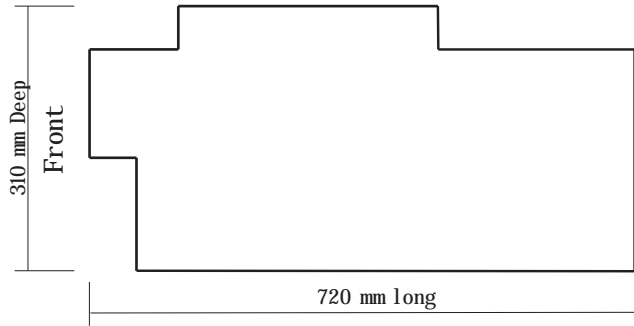

Passengers Side

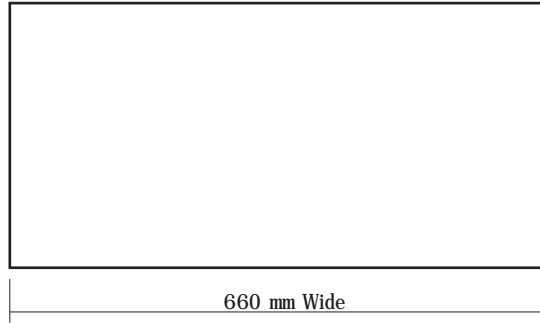

Rear View



Drivers Side

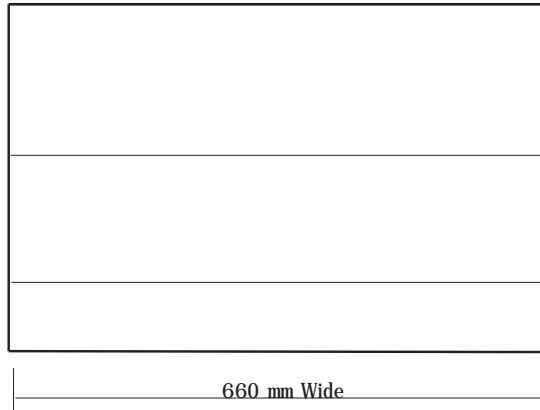
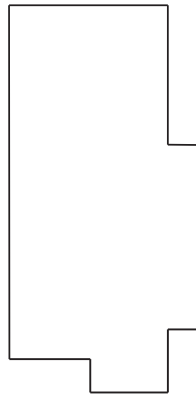

Plan View

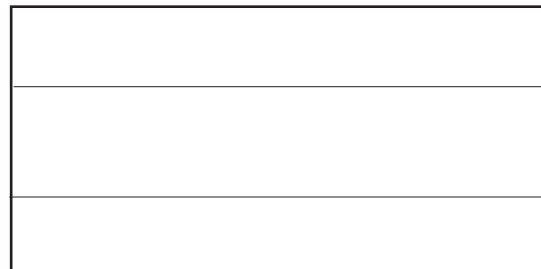
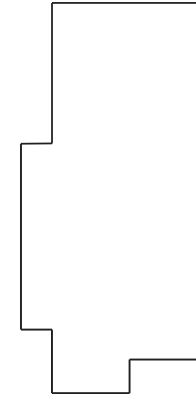

Front View

Please clearly mark where you require fitting locations and sizes.

Mercedes Sprinter 2007 XL Model	
Tank: Tank One A 120 litres	
Atlas Tanks	January 2007

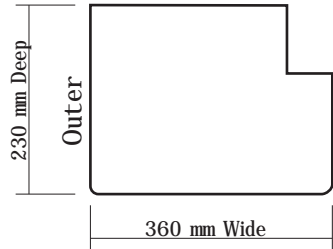

Front View

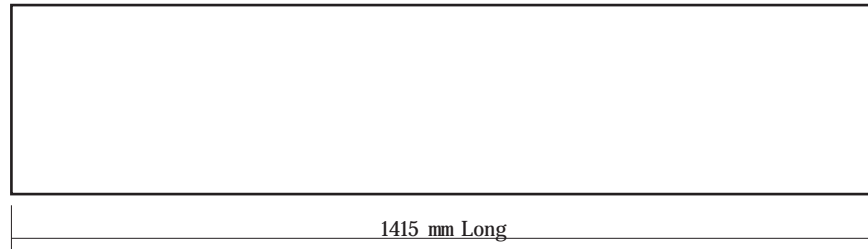

Outer Side View

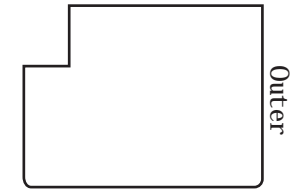

Rear View

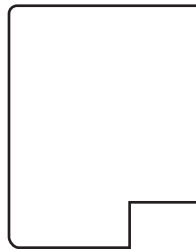

Plan View

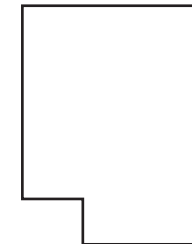
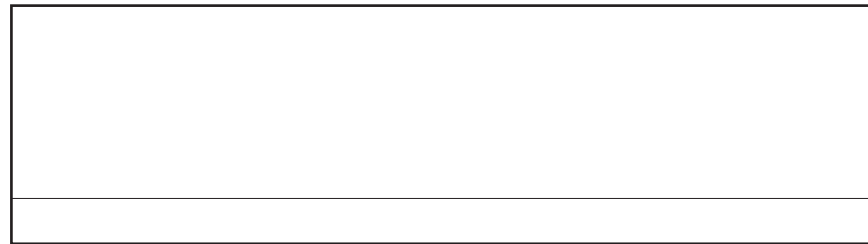

Inner Side View

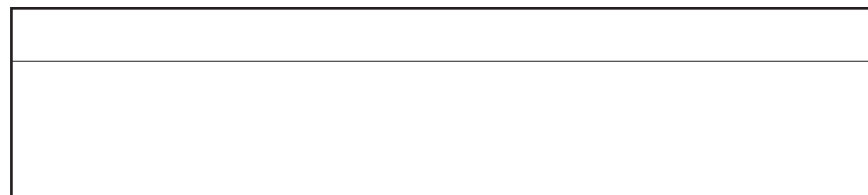

Please clearly mark where you require fitting locations and sizes.

Mercedes Sprinter 2007 Model	
Tank: Tank Two 110 litres	
Atlas Tanks	January 2007